

Mini Dome Camera



Features

- Sony Super HAD CCD sensor
- Built-in Cone Lens 3.7 mm
- In-ceiling or Surface installation application
- Aluminum casing



? In-ceiling



? Surface

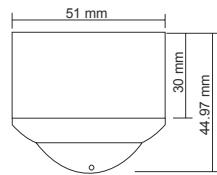
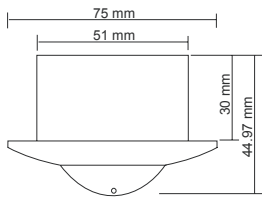

Model No.	RYK-2C54	RYK-3C76
Image Device	1/3" Color Sony Super HAD	1/3" B/W Sony Super HAD
Picture Elements	NTSC:510x492, PAL:500x582	EIA:510x492, CCIR:500x582
Resolution	380 TVL	420 TVL
Min. Illumination	0.4 Lux / F2.0	0.1 Lux / F2.0
S/N Ratio	More than 48 dB	
Electronic Shutter	NTSC:1/60~1/100,000, PAL:1/50~1/110,000	EIA:1/60~1/100,000, CCIR:1/50~1/110,000
Gamma	0.45	
Lens Mount	Cone Lens 3.7mm / F2.0	
White Balance	Auto	-
Gain Control	Auto	
Sync. System	Internal	
Video Output	1 Vp-p / 75 Ohms	
Power Supply	DC12V ±10%	
Power Consumption	117mA max.	100mA max.
Operating Temp.	-10° ~ 50°	

Digital Surveillance Solution from Home to Enterprise